

Runcorn Town Deal Pictorial Projects Update



Funded by
UK Government

Reconnecting
RUNCORN

<https://reconnectingruncorn.info/>

Brindley Theatre Extension

Transforming the already award-winning theatre with a refreshed design, making the Brindley more visible and accessible, taking advantage of a new outdoor public realm and vistas connecting to the town.



Brindley Green



High Street Connectivity – St Paul's Mews



To be able to open up the high street more this project includes the demolition of a couple of unused buildings. One of the key project strands this feeds into is The Brindley Green.

High Street Connectivity High Street Public Realm

Improving the connectivity, accessibility and environment on key routes around the town centre & in turn reduce congestion and pollution in the town centre. In a push to improve ability of active lifestyles within the community this is set to include more pedestrian friendly paths, cycle lanes & new taxi rank.



Health and Education Hub

- | | | |
|-----------------------|-------------------------|--------------------------------------|
| 1 Community Zone | 7 Clean Utility Room | 13 Server Room, Gas & Electric Store |
| 2 Creche Play Area | 8 Dirty Utility Room | 14 MDT/ Group Consult Room |
| 3 Gym | 9 Counseling Room | 15 Waiting Area |
| 4 Storage Room | 10 Admin & Support Room | 16 Sample WC. |
| 5 Lift & Stair Access | 11 Consultation Room | 17 Staff W.C & Shower |
| 6 Public Toilets | 12 Phlebotomy Room | 18 Staff Room |



A mixed-use hub delivering health and education services and providing access to a wide range of health, wellbeing and training services situated in the current Granville Library building. The services are aimed at families, young people and residents living with long-term conditions. Giving the community better access to health services, as well as further education and job-seeking support in a 'one stop' facility.

Creative and Digital Skills Centre 71 High Street

The restoration of this Georgian building is the first of the creative and Digital Skills Hub. Seeing the expansion of Hazlehurst Studios into the space has provided high quality studio space for artists and creatives, incorporating accessible ground floor workspaces for artists to work in and hold community workshops and exhibitions in.



Creative and Digital Skills Centre 57 59 and 63 65 High Street



57/59: Development of a Victorian shop building with heritage value with an adjoining new build to house Youthy.com- a youth centre for the young people of Runcorn.

63/65The Centre will host Mako Create to deliver digital skills training and A Place For Us theatre company to offer performing arts for the local community



High Street Connectivity Temple New Hall & Peace Garden

The Peace garden was built on a derelict triangle of land which was unused by anyone. It is now a relaxing area with an impressive six-metre hollow, bronzed statue in the centre.



High Street Connectivity – Temple New Hall & Peace Garden



High Street Connectivity Temple New Hall & Peace Garden

Situated in the temple car park this is set to become a new landmark building near Waterloo Bridge. Becoming just the third Ubosot Hall in the UK. Not only will this building hold significance for the temple but also the community of Runcorn, as large community space.

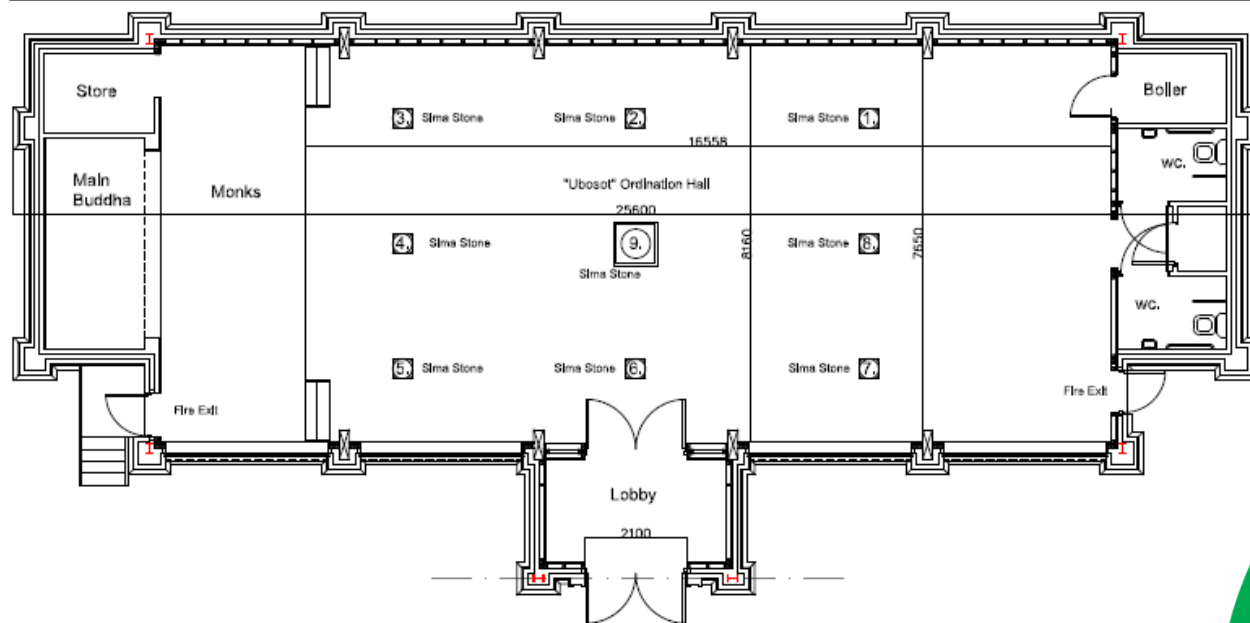

High Street Connectivity Street Art

Exploring the town of Runcorn on foot is about to become even more enjoyable. Between the High Street near the Bridgewater Canal and River Mersey, art will be displayed on the viaduct piers from 1961. The artist concept is showcasing some local history from the Dukesfield area, to blend art with the town's unique history



Town Centre New Homes High Street



The building of 65 self-contained apartments on Runcorn High Street for over 55's. This will provide much needed additional fully accessible quality homes, specifically designed for the older generation & located on the High Street, giving residents easier access to the facilities & offerings in the town centre.



Town Centre New Homes Rutland Street Area

Community led housing scheme. The remediation of land in Rutland Street in preparation for a newly formed Community Land Trust to take forward the design and build of much needed mixed use community housing



Unlock Runcorn – Civils, Landscaping

The creation of a landscaped area between Runcorn Station and the new Peace Garden temple. It will also see a small extension to the canal where the boats used for boat trips can be moored.

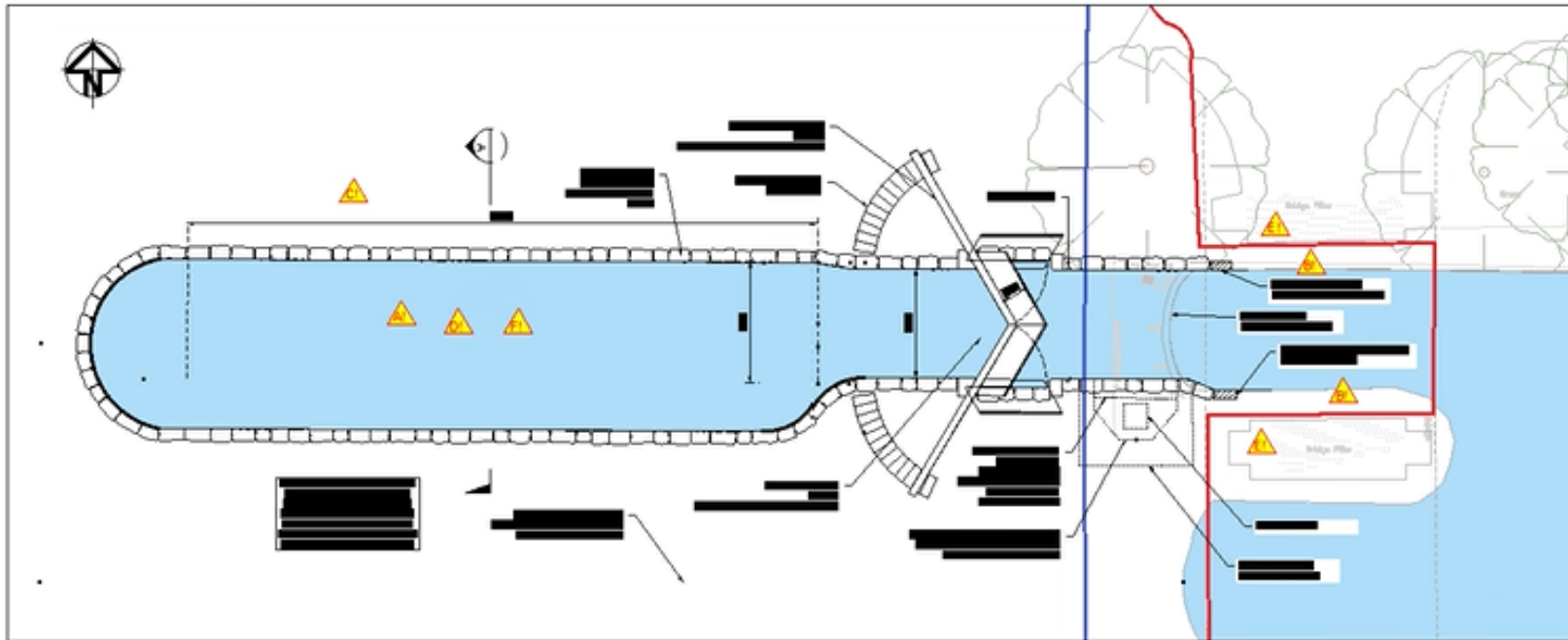

General arrangement
1:100

Unlock Runcorn Trip Boat, Visitor Café Point, Events Programme



The ultimate goal for this strand is the creation of a visitor centre and café for visitors to enjoy and find out more about the canal, as well as the introduction of boat trips along a section of the Canal and an events programme to run throughout the year. Led by Runcorn Locks Restoration Society (RLRS).

Runcorn Station Quarter Enterprise Facility

Creation of a co-working incubator space located close to the Runcorn West Coast mainline station. Providing quality office space, meeting room hire, event space hire and various ancillary uses at ground floor level such as a café, retail or toilets. Working with the wider business community in Runcorn, including the Creative and Digital Skills Centre on the High Street and Sci-Tech Daresbury and the Digital Cluster.

